

Avery Weigh-Tronix
Remote Displays



PROCESS WEIGHING

COUNTING SCALES

BENCH SCALES

CHECKWEIGHERS

CONVEYOR SCALES

FLOOR SCALES

INDICATORS

RAILROAD SCALES

SOFTWARE

REMOTE DISPLAYS

JUNCTION BOXES

SIGNAL PROCESSING

FORKLIFT SCALES

MONORAIL SCALES

PRINTERS

TRUCK SCALES

REMOTE DISPLAYS

Avery Weigh-Tronix remote displays allow clear, comfortable viewing of scale information at considerable distances, indoors and outdoors. Popular options such as wireless RF connectivity and integrated traffic light are available.



Avery Weigh-Tronix

Avery Weigh-Tronix remote displays provide outstanding value with a long list of standard features and are engineered for many years of reliable performance.

Bigger. Brighter. Smarter



XR 2000



XR 4500 shown with wireless option

XR SERIES LED REMOTE DISPLAYS

The XR Series offers a choice of 2 inch, 4.5 inch or 6.5 inch digits. The 4.5 inch model can be ordered with an integrated red/green traffic light. The high intensity (Precision Optical Performance) red LED lamps create a display that is clearly visible in all indoor or outdoor light conditions including direct sunlight. The advanced Auto-Learn technology allows simple plug-and-play operation with virtually any indicator or PC. A durable, weather-tight enclosure protects the XR Series in harsh environments. Standard features include six digits, four annunciators for GR (gross), NT (net), lb, kg and decimal points indication. All models are ready for the easy to-install RF option for wireless communication.

Super Bright LED Display

High quality display is clearly visible in any lighting condition. Ambient light sensor automatically adjusts display brightness for night and day. Highly efficient LEDs virtually never need replacement and lower energy costs.



XR 4500TL shown with standard traffic light



XR 6500



Auto-Learn Technology

Connect the remote to virtually any instrument and it will automatically learn the data string and communicate, reducing set-up time.

Integrated Traffic Light

Built-in red/green traffic light on XR 4500TL. No need to install a separate traffic light.

Easy Servicability

Electronics carriage lowers from bottom for easy access.

Mirrored Display Mode

For units that will be viewed in rear-view mirrors.

Pre-installed Utility Programs

Extremely flexible in many applications from axle weighing and totalizing to cattle auctioning.

Time and Date Display

Standard feature on XR4500, XR4500TL and XR6500. Time and date will display during periods of scale inactivity.

External Keypad

Easy to change settings or adjust time and date without opening the unit. No internal dip switches or jumper wires to mess with.

OPTIONS

Wireless RF Option

As simple as plugging a module into the controller board inside the display and adding a base unit to the indicator.

Visor Option

Visor provides additional level of protection against the elements.

Pole Mount Kit Option

Convenient bracket system that can be attached to various pole sizes and shapes.

Temperature Option

Easy to add probe at bottom of unit for temperature sensing, which can be displayed during periods of scale inactivity.



Optional visor on XR4500

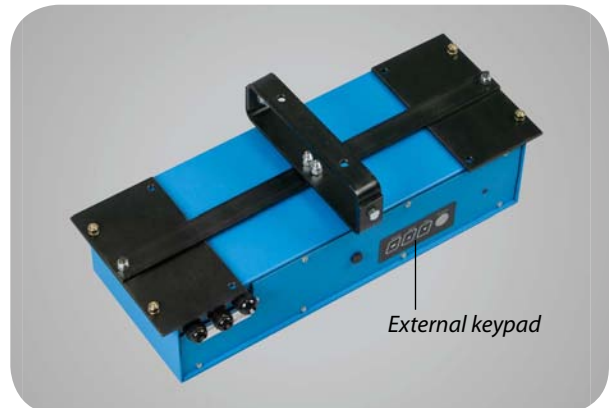

Optional pole mount kit



Optional temperature display during inactivity



Power

- > Input — 90 to 240VAC, 50/60Hz
- > 115/230VAC auto-sensing power supply
- > Consumption — 25 watt (60 watt max)

Display Characters

- > 6 digit, 7 segment, high intensity (Precision Optical Performance) red LED lamps.
- > XR 2000: 2" characters, 60 ft viewing range
- > XR 4500 / XR 4500TL: 4.5" characters, 275 ft viewing range
- > XR 6500: 6.5" characters, 325 ft viewing range
- > XR 4500 / XR 4500TL / XR 6500: 1 or 2 decimals
- > XR 2000: up to 5 decimals

Input Data Interface:

- > RS-232, RS-485, 20mA current loop (active or passive), wireless RF

Data Format:

- > Baud rates — 300 to 19,200, Auto-Learning or selectable
- > 7 or 8 data bits; even, odd, or no parity; 1 or 2 stop bits, Auto-Learning or selectable

Output Interface:

- > Echo out port – RS-232

Update:

- > Continuous or demand, selectable

Operating Environment

- > -40° F to 120° F (-40° C to 50° C), 0% to 100% humidity, non-condensing

Enclosure

- > Weatherproof, powder-coated, mild steel
- > Non-glare, contrast lens

Shipping Weight:

- > XR 2000: 6 lb (3 kg)
- > XR 4500: 18 lb (9 kg)
- > XR 4500TL / XR 6500: 32 lb (15 kg)

Warranty

2 year limited

Dimensions:

- > XR 2000: 12.88"W x 6"H x 2.25"D
(326.4 mm x 152.4 mm x 57.2 mm)
- > XR 4500: 24"W x 10"H x 5"D
(609.6 mm x 254 mm x 127 mm)
- > XR 4500TL / XR 6500: 32"W x 12"H x 5"D
(812.8 mm x 304.8 mm x 127 mm)

XR 2000

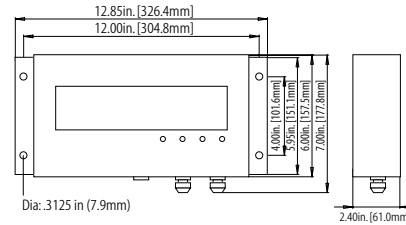

XR 4500

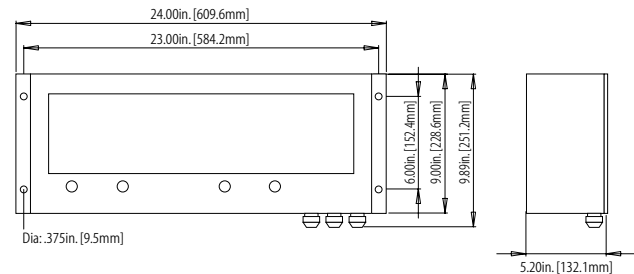

XR 4500TL / XR6500

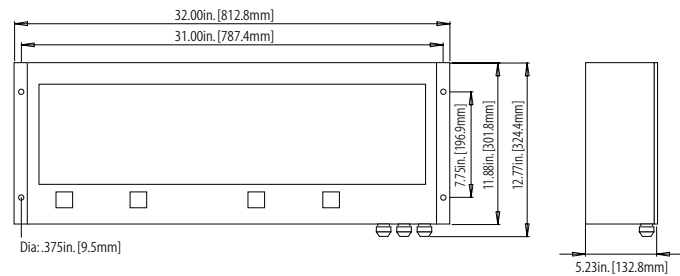

Avery Weigh-Tronix

Avery Weigh-Tronix - USA

1000 Armstrong Drive,
Fairmont, MN 56031-1439 USA
usinfo@awtxglobal.com
Toll-Free: (800) 533-0456
Phone: (507) 238-4461

Avery Weigh-Tronix - UK

Foundry Lane, Smethwick,
West Midlands B66 2LP UK
info@awtxglobal.com
Phone: +44 (0) 8453 66 77 88
Fax: +44 (0) 121 224 8183

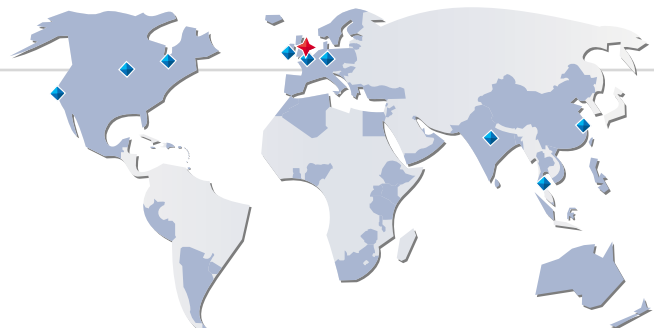

Please call us or visit www.averyweigh-tronix.com
for your nearest Avery Weigh-Tronix distributor

